

NOTE:  
AAR APPROVAL # E-182113.

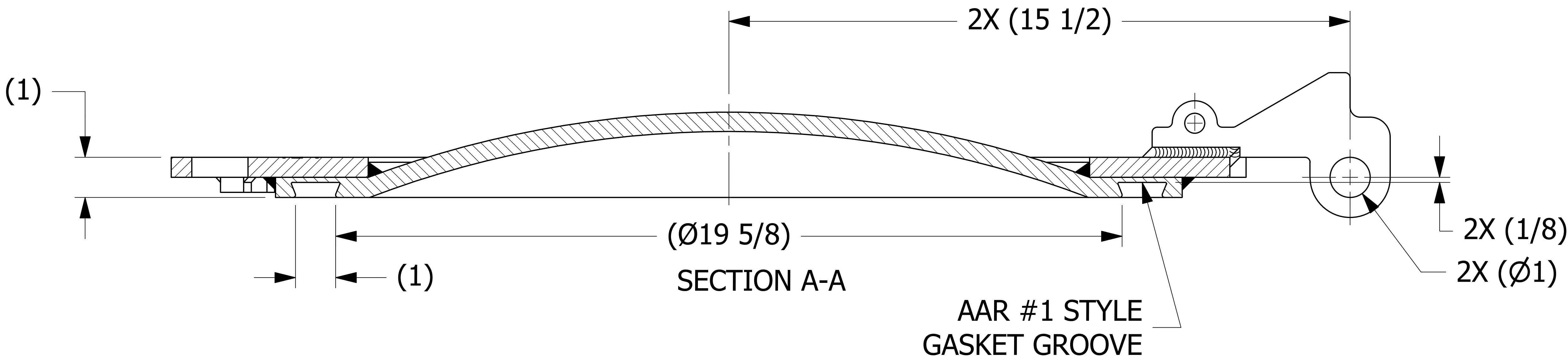

F	WEB	5-20-19	REMOVED QAP4A-1 NOTE; Q-2.15.7 WAS QAP4C-1; D-008 WAS DSS 12; ADDED D-005 NOTE; AAR # WAS E-089005
E	RJP	10-5-17	HINGE WELD WAS 3/8"; 4.00 +.00/-.06 WAS 4.00; ADDED NOTE 6; ADDED "SALCO" TO ENGRAVING; UPDATED WELD NOTE
D	RJP	1-25-17	TMCDR20924 WAS TMCR209C1 & TMCDSS6MF, A28439 WAS A14392, B40713 WAS B41297, 2X .13 WAS 2X (1/8), REMOVED (12 1/2), 6X (11 61/64), 4 X .38, & QAP5A-1 MARKING, ADDED (12 29/32), 4X .75, 2X (Ø1), & LOT CONTROL
C	RJP	5-19-15	B41297 WAS TMCHS4TR, UPDATED TMCR209C1 GEOMETRY
B	BG	5-7-13	ADDED 15.50 DIMENSION
A	BG	11/19/12	NEW PART ADDED TO THE NETWORK
REV	BY	DATE	DESCRIPTION

UNLESS OTHERWISE SPECIFIED DIMENSIONAL TOLERANCES FRACTIONAL: ±1/16 X.XX: ±.03 X.XXX: ±.015 ANGULAR: ±1° DEBURR ALL SHARP EDGES. ALL MACHINED SURFACES TO HAVE A 125 RMS FINISH UNLESS NOTED OTHERWISE. THIRD ANGLE PROJECTION	DRAWN BY:	JJK
	CHECKED BY:	CHL
	PROTOTYPE BY:	JJK
	PROTOTYPE DATE:	3/15/2012
	APPROVED FOR PRODUCTION BY:	CHL
	PRODUCTION DATE:	11/19/2012

SALCO PRODUCTS, INC.			
PART NAME: MANWAY COVER 20" 8-BOLT			
MATERIAL: CS/316L SS			
PROJECT #:	120307	SHEET #:	1 OF 1
DRAWING #:	E32717	PART #:	TMC20924
SCALE:		2:3	